

## Specification Status: RELEASED

**Maximum Operating Voltage:** 60V<sub>DC</sub>

**Fault Ratings at 20°C:**

250 V<sub>RMS</sub>, 3A, 10 applications  
600 V<sub>RMS</sub>, 1A, 5 applications

**Additional Info at 20°C:**

Resistance matched: N/A  
Lightning withstand: 1.5kV per ITU-T  
Helps equipment meet ITU-T K.20/K.21 specifications

**Terminal Material:** Tin-Plated Brass

**Marking:**

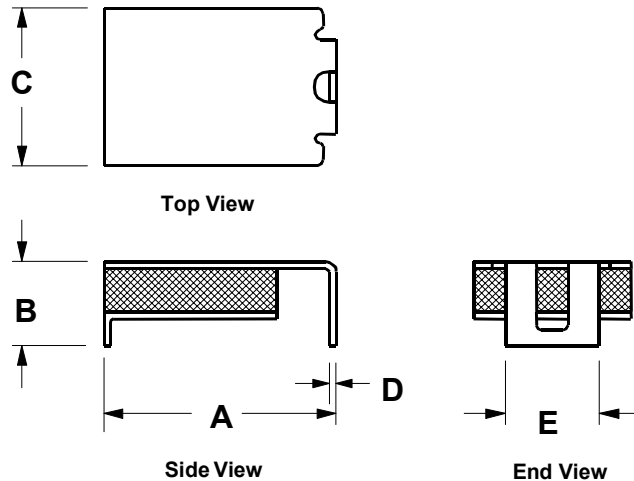
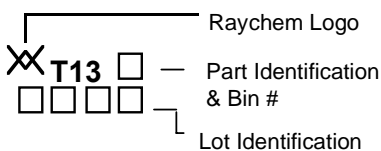

**TABLE I. DIMENSIONS:**

	A		B		C		D NOM	E NOM
	MIN	MAX	MIN	MAX	MIN	MAX		
mm:	8.5	9.4	--	3.4	--	7.4	0.3	3.8
in:	(0.335)	(0.370)	--	(0.135)	--	(0.290)	(0.011)	(0.150)

\*Rounded off approximation

**TABLE II. PERFORMANCE RATINGS @ 20°C (unless otherwise noted):**

HOLD CURRENT (A)	TRIP CURRENT (A)	RESISTANCE (Ω)			TIME TO TRIP(Sec) @ 1A		OPERATING TEMPERATURE (°C)		TRIPPED POWER DISSIPATION (W) TYP @ 60V <sub>DC</sub>
		R MIN	R MAX	R <sub>1MAX</sub> *	TYP	MAX	MIN	MAX	
0.130	0.260	6.5	12.0	20.0	0.9	2.5	-40	85	1.1

\*Maximum device resistance at 20°C measured 1 hour post trip and 24 hours post reflow

**TABLE III. APPLICABLE PART DESCRIPTIONS:**

PART DESCRIPTION	PCN # (INTERNAL ONLY)	PACKAGING TYPE	NOTE
TS250-130F-2	E44331-000	Tape and Reel	N/A

Agency Recognitions: UL, CSA, TUV  
UL File #E74889, CSA File #78165C

Reference Documents: Raychem PS300, ITU-T K.20/K.21

Precedence: This specification takes precedence over documents referenced herein.

Effectivity: Reference documents shall be the issue in effect on the date of invitation for bid.

Caution: Operation beyond the rated voltage or current may result in rupture, electrical arcing or flame.

**Materials Information**

ROHS Compliant

ELV Compliant

Pb-Free

